

Accesorios PE Inyectado para Tuberías PE-100

TARIFA PVP A-Presión



Los accesorios de la gama EUROSTANDARD están fabricados en polietileno PE100 y están moldeados por inyección con extremo de espiga largo, utilizando un compuesto PE100 adecuado para tuberías para la distribución de gas, agua y fluidos bajo presión.

La gama se compone de racores para polifusión, accesorios de transición, accesorios electrosoldables, así como unidades de soldadura y otros equipos.

Las características son conformes a las normas EN 1555-3, EN 12201-3, EN ISO 15494.

Todos los accesorios PE100 son soldables con tuberías PE80 accesorios y viceversa, ya sea usando polifusión o sistema de electrofusión.

Certificaciones

EuroStandard además de estar certificado en sus procesos de producción para las normas ISO 9001, ISO 14001, tiene acreditación por Acredia, su laboratorio de ensayos y pruebas, EUROLAB.

Además a fecha 2016 dispone de certificaciones en todos los países que opera; DVGW de Alemania, NF Certigaz en Francia, WRAS de Reino Unido, Insta-Cert en Suecia, Gas Natural y RePro en España, etc..

Disponibilidad: ● Stock, □ 5-6 días, *Consultar

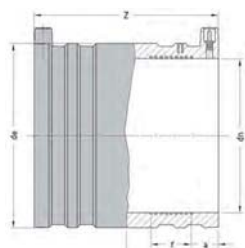

MANGUITO ELECTROSOLDABLE PN10-SDR17

| dn | Dimensiones (mm) | | | | | | ud/caja | Código |
|-------|------------------|-----|----|----|-----|---|-------------|--------|
| | de | L | f | a | Z | | | |
| • 160 | 198 | 86 | 39 | 22 | 172 | 1 | 1 22 02 160 | |
| • 180 | 223 | 100 | 41 | 25 | 199 | 1 | 1 22 02 180 | |
| • 200 | 233 | 106 | 42 | 30 | 212 | 1 | 1 22 02 200 | |
| □ 225 | 262 | 114 | 41 | 35 | 227 | 1 | 1 22 02 225 | |
| • 250 | 292 | 122 | 45 | 42 | 244 | 1 | 1 22 02 250 | |
| □ 280 | 341 | 133 | 42 | 44 | 265 | 1 | 1 22 02 280 | |
| • 315 | 369 | 138 | 47 | 44 | 275 | 1 | 1 22 02 315 | |
| □ 355 | 430 | 156 | 40 | 47 | 312 | 1 | 1 22 02 355 | |
| • 400 | 461 | 170 | 60 | 41 | 340 | 1 | 1 22 02 400 | |

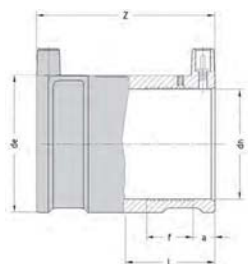

MANGUITO ELECTROSOLDABLE PN16-SDR11

| dn | Dimensiones (mm) | | | | | | ud/caja | Código |
|--|------------------|-----|----|----|-----|----|-------------|--------|
| | de | L | f | a | Z | | | |
| • 20 | 33 | 33 | 15 | 13 | 70 | 35 | 1 24 02 020 | |
| • 25 | 38 | 33 | 15 | 12 | 70 | 30 | 1 24 02 025 | |
| • 32 | 46 | 38 | 19 | 12 | 80 | 20 | 1 24 02 032 | |
| • 40 | 56 | 44 | 22 | 13 | 90 | 12 | 1 24 02 040 | |
| • 50 | 68 | 49 | 23 | 14 | 100 | 16 | 1 24 02 050 | |
| • 63 | 82 | 54 | 26 | 18 | 111 | 20 | 1 24 02 063 | |
| • 75 | 93 | 61 | 36 | 15 | 121 | 16 | 1 24 02 075 | |
| • 90 | 114 | 66 | 37 | 15 | 132 | 16 | 1 24 02 090 | |
| • 110 | 137 | 70 | 36 | 18 | 140 | 12 | 1 24 02 110 | |
| • 125 | 153 | 76 | 39 | 18 | 152 | 1 | 1 24 02 125 | |
| • 140 | 171 | 82 | 48 | 19 | 163 | 1 | 1 24 02 140 | |
| • 160 | 198 | 86 | 45 | 22 | 172 | 1 | 1 24 02 160 | |
| • 180 | 223 | 100 | 51 | 25 | 198 | 1 | 1 24 02 180 | |
| • 200 | 247 | 105 | 42 | 32 | 211 | 1 | 1 24 02 200 | |
| • 225 | 278 | 113 | 48 | 36 | 226 | 1 | 1 24 02 225 | |
| • 250 | 308 | 122 | 53 | 33 | 244 | 1 | 1 24 02 250 | |
| • 280 | 341 | 133 | 55 | 38 | 265 | 1 | 1 24 02 280 | |
| • 315 | 391 | 138 | 70 | 33 | 275 | 1 | 1 24 02 315 | |
| • 355 | 430 | 156 | 60 | 45 | 312 | 1 | 1 24 02 355 | |
| • 400 | 497 | 171 | 53 | 64 | 343 | 1 | 1 24 02 400 | |
| MANGUITO ELECTROSOLDABLE PN12,5-SDR13,6 | | | | | | | | |
| • 450 | 527 | 175 | 59 | 45 | 350 | 1 | 1 23 02 450 | |
| • 500 | 585 | 179 | 76 | 47 | 359 | 1 | 1 23 02 500 | |
| • 560 | 656 | 195 | 90 | 50 | 390 | 1 | 1 23 02 560 | |
| • 630 | 736 | 210 | 99 | 50 | 420 | 1 | 1 23 02 630 | |

TARIFA PVP A-Presión

Accesorios PE Electrosoldable
para Tuberías PE-100

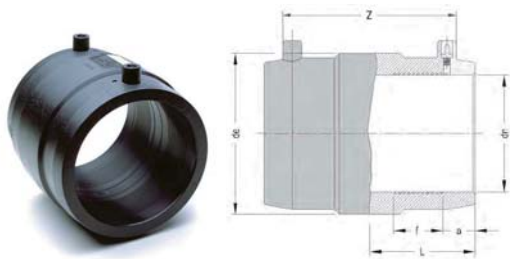

MANGUITO ELECTROSOLDABLE PN25-SDR7,4

| dn | Dimensiones (mm) | | | | | | ud/caja | Código |
|-------|------------------|-----|----|----|-----|----|-------------|--------|
| | de | L | f | a | Z | | | |
| □ 20 | 33 | 33 | 15 | 13 | 70 | 35 | 1 26 02 020 | |
| □ 25 | 38 | 33 | 15 | 12 | 70 | 30 | 1 26 02 025 | |
| □ 32 | 46 | 38 | 19 | 12 | 80 | 20 | 1 26 02 032 | |
| □ 40 | 56 | 44 | 22 | 13 | 90 | 12 | 1 26 02 040 | |
| ● 50 | 68 | 49 | 23 | 14 | 100 | 16 | 1 26 02 050 | |
| ● 63 | 82 | 54 | 26 | 18 | 111 | 20 | 1 26 02 063 | |
| ● 75 | 99 | 60 | 36 | 14 | 120 | 16 | 1 26 02 075 | |
| ● 90 | 116 | 65 | 37 | 14 | 130 | 16 | 1 26 02 090 | |
| ● 110 | 145 | 70 | 36 | 18 | 140 | 12 | 1 26 02 110 | |
| ● 125 | 163 | 76 | 39 | 18 | 151 | 1 | 1 26 02 125 | |
| □ 140 | 183 | 81 | 48 | 18 | 161 | 1 | 1 26 02 140 | |
| ● 160 | 207 | 86 | 53 | 20 | 172 | 1 | 1 26 02 160 | |
| □ 180 | 233 | 97 | 56 | 23 | 193 | 1 | 1 26 02 180 | |
| ● 200 | 260 | 101 | 65 | 22 | 203 | 1 | 1 26 02 200 | |
| □ 225 | 292 | 112 | 67 | 22 | 223 | 1 | 1 26 02 225 | |
| □ 250 | 324 | 122 | 60 | 32 | 244 | 1 | 1 26 02 250 | |
| □ 315 | 408 | 142 | 70 | 37 | 284 | 1 | 1 26 02 315 | |

Disponibilidad: ● Stock, □ 5-6 días, *Consultar



CODO ELECTROSOLDABLE 90°

| dn | Dimensiones (mm) | | | | | | PN SDR | ud/caja | Código |
|-------|------------------|-----|----|----|-----|----------------|--------|-------------|--------|
| | de | L | f | a | Z | | | | |
| • 20 | 34 | 33 | 15 | 10 | 55 | PN 25 -SDR 7,4 | 20 | 1 26 12 020 | |
| • 25 | 38 | 33 | 15 | 9 | 57 | | 15 | 1 26 12 025 | |
| • 32 | 46 | 39 | 18 | 10 | 75 | | 18 | 1 26 12 032 | |
| • 40 | 56 | 48 | 25 | 11 | 80 | | 12 | 1 26 12 040 | |
| • 50 | 68 | 54 | 27 | 12 | 89 | | 16 | 1 26 12 050 | |
| • 63 | 83 | 52 | 27 | 13 | 104 | | 10 | 1 26 12 063 | |
| • 75 | 97 | 64 | 29 | 18 | 116 | | 6 | 1 26 12 075 | |
| • 90 | 116 | 70 | 37 | 18 | 130 | | 8 | 1 26 12 090 | |
| • 110 | 142 | 76 | 39 | 20 | 146 | | 5 | 1 24 12 110 | |
| • 125 | 162 | 79 | 42 | 19 | 152 | | 1 | 1 24 12 125 | |
| • 140 | 174 | 85 | 38 | 20 | 166 | PN 16 - SDR 11 | 1 | 1 24 12 140 | |
| • 160 | 206 | 89 | 45 | 20 | 180 | | 1 | 1 24 12 160 | |
| • 180 | 226 | 116 | 50 | 23 | 215 | | 1 | 1 24 12 180 | |
| • 200 | 251 | 118 | 55 | 23 | 229 | | 1 | 1 24 12 200 | |

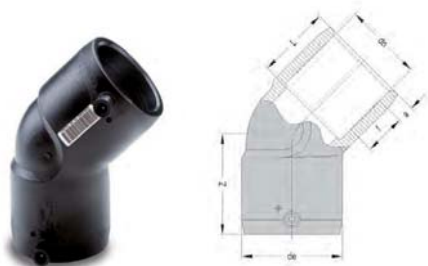

CODO ELECTROSOLDABLE 45°

| dn | Dimensiones (mm) | | | | | | PN SDR | ud/caja | Código |
|-------|------------------|-----|----|----|-----|-----------------|----------------|-------------|-------------|
| | de | L | f | a | Z | | | | |
| • 25 | 39 | 33 | 15 | 10 | 55 | PN 25 - SDR 7,4 | 18 | 1 26 20 025 | |
| • 32 | 46 | 39 | 18 | 10 | 57 | | 20 | 1 26 20 032 | |
| • 40 | 56 | 48 | 25 | 11 | 70 | | 12 | 1 26 20 040 | |
| • 50 | 68 | 54 | 27 | 12 | 75 | | 9 | 1 26 20 050 | |
| • 63 | 82 | 52 | 27 | 13 | 86 | | 10 | 1 26 20 063 | |
| • 75 | 97 | 64 | 29 | 18 | 98 | | 6 | 1 26 20 075 | |
| • 90 | 116 | 70 | 37 | 18 | 110 | | 8 | 1 26 20 090 | |
| • 110 | 142 | 76 | 39 | 20 | 114 | | 5 | 1 26 20 110 | |
| • 125 | 162 | 79 | 42 | 19 | 119 | | 1 | 1 24 20 125 | |
| • 140 | 177 | 86 | 39 | 20 | 134 | | PN 16 - SDR 11 | 1 | 1 24 20 140 |
| • 160 | 206 | 89 | 45 | 20 | 134 | 1 | | 1 24 20 160 | |
| • 180 | 223 | 105 | 50 | 28 | 165 | 1 | | 1 24 20 180 | |
| • 200 | 250 | 112 | 55 | 29 | 171 | 1 | | 1 24 20 200 | |

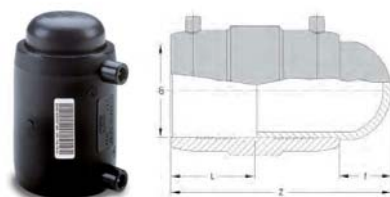

TAPÓN ELECTROSOLDABLE

| dn | PN - SDR | Dimensiones (mm) | | | ud/caja | Código | |
|-------|-------------|------------------|-----|-----|---------|-------------|-------------|
| | | f | L | Z | | | |
| • 20 | PN25-SDR7,4 | 30 | 33 | 100 | 30 | 1 26 60 020 | |
| • 25 | | 27 | 33 | 104 | 25 | 1 26 60 025 | |
| • 32 | | 31 | 38 | 98 | 16 | 1 24 60 032 | |
| • 40 | | 29 | 44 | 114 | 10 | 1 24 60 040 | |
| • 50 | | 32 | 49 | 127 | 12 | 1 24 60 050 | |
| • 63 | | 49 | 55 | 136 | 18 | 1 24 60 063 | |
| • 75 | | 41 | 61 | 162 | 15 | 1 24 60 075 | |
| • 90 | | PN16-SDR11 | 42 | 66 | 174 | 15 | 1 24 60 090 |
| • 110 | | | 49 | 70 | 189 | 10 | 1 24 60 110 |
| • 125 | | | 42 | 76 | 194 | 1 | 1 24 60 125 |
| □ 140 | 51 | | 82 | 214 | 1 | 1 24 60 140 | |
| • 160 | 48 | | 86 | 220 | 1 | 1 24 60 160 | |
| □ 180 | 50 | | 100 | 249 | 1 | 1 24 60 180 | |

Disponibilidad: ● Stock, □ 5-6 días, *Consultar

TARIFA PVP A-Presión

Accesorios PE Electrosoldable
para Tuberías PE-100



TE IGUAL ELECTROSOLDABLE 90° SDR 11 PN16

| dn | Dimensiones (mm) | | | | | | | ud/caja | Código |
|-------|------------------|-----|----|-----|-----|-----|----|-------------|--------|
| | de | L | f | h | Z | Z1 | | | |
| • 25 | 39 | 33 | 15 | 60 | 53 | 111 | 20 | 1 24 32 025 | |
| • 32 | 44 | 44 | 28 | 48 | 64 | 94 | 18 | 1 24 32 032 | |
| • 40 | 54 | 49 | 37 | 57 | 73 | 112 | 10 | 1 24 32 040 | |
| • 50 | 66 | 55 | 36 | 62 | 81 | 128 | 14 | 1 24 32 050 | |
| • 63 | 81 | 61 | 32 | 72 | 94 | 153 | 8 | 1 24 32 063 | |
| • 75 | 96 | 64 | 29 | 75 | 113 | 176 | 4 | 1 24 32 075 | |
| • 90 | 116 | 70 | 37 | 85 | 125 | 202 | 6 | 1 24 32 090 | |
| • 110 | 141 | 76 | 39 | 84 | 141 | 233 | 4 | 1 24 32 110 | |
| • 125 | 161 | 79 | 42 | 100 | 156 | 269 | 1 | 1 24 32 125 | |
| • 140 | 174 | 85 | 38 | 121 | 150 | 308 | 1 | 1 24 32 140 | |
| • 160 | 206 | 89 | 51 | 127 | 184 | 350 | 1 | 1 24 32 160 | |
| • 180 | 227 | 105 | 48 | 130 | 188 | 368 | 1 | 1 24 32 180 | |
| • 200 | 252 | 112 | 55 | 135 | 205 | 400 | 1 | 1 24 32 200 | |



REDUCCIÓN ELECTROSOLDABLE H-H SDR11 / PN16

| dn | dn1 | Dimensiones (mm) | | | | | | | | ud/caja | Código |
|-----|-------|------------------|-----|-----|----|----|----|-----|----|-------------|--------|
| | | de | de1 | L | L1 | f | f1 | Z | | | |
| 32 | • 20 | 44 | 32 | 46 | 38 | 34 | 22 | 105 | 16 | 1 24 06 033 | |
| | • 25 | 45 | 36 | 44 | 45 | 31 | 21 | 103 | 16 | 1 24 06 032 | |
| 40 | • 20 | 55 | 33 | 49 | 39 | 27 | 22 | 120 | 10 | 1 24 06 042 | |
| | • 25 | 55 | 36 | 48 | 40 | 27 | 21 | 114 | 10 | 1 24 06 041 | |
| 50 | • 32 | 55 | 44 | 54 | 50 | 30 | 29 | 109 | 10 | 1 24 06 040 | |
| | • 25 | 67 | 37 | 49 | 40 | 27 | 21 | 126 | 6 | 1 24 06 052 | |
| 50 | • 32 | 66 | 44 | 53 | 49 | 30 | 29 | 121 | 6 | 1 24 06 051 | |
| | • 40 | 66 | 54 | 55 | 54 | 33 | 33 | 119 | 6 | 1 24 06 050 | |
| 63 | • 32 | 81 | 46 | 62 | 44 | 31 | 24 | 156 | 8 | 1 24 06 065 | |
| | • 40 | 81 | 54 | 63 | 54 | 29 | 20 | 137 | 8 | 1 24 06 064 | |
| 63 | • 50 | 81 | 66 | 62 | 54 | 26 | 23 | 131 | 8 | 1 24 06 063 | |
| | • 50 | 97 | 66 | 70 | 54 | 34 | 30 | 154 | 8 | 1 24 06 076 | |
| 75 | • 63 | 97 | 81 | 75 | 62 | 34 | 33 | 160 | 8 | 1 24 06 075 | |
| | • 50 | 117 | 66 | 79 | 55 | 45 | 25 | 185 | 8 | 1 24 06 092 | |
| 90 | • 63 | 115 | 81 | 77 | 62 | 45 | 33 | 160 | 8 | 1 24 06 091 | |
| | • 75 | 115 | 97 | 81 | 60 | 39 | 30 | 159 | 6 | 1 24 06 090 | |
| 110 | • 63 | 144 | 93 | 79 | 63 | 40 | 33 | 201 | 4 | 1 24 06 112 | |
| | • 90 | 141 | 115 | 87 | 77 | 41 | 39 | 171 | 4 | 1 24 06 110 | |
| 125 | • 90 | 162 | 118 | 78 | 68 | 42 | 34 | 177 | 1 | 1 24 06 126 | |
| | • 110 | 162 | 144 | 79 | 73 | 33 | 36 | 164 | 1 | 1 24 06 125 | |
| 160 | • 90 | 209 | 119 | 90 | 79 | 50 | 40 | 233 | 1 | 1 24 06 163 | |
| | • 110 | 208 | 144 | 95 | 82 | 48 | 37 | 218 | 1 | 1 24 06 162 | |
| 160 | • 125 | 208 | 162 | 98 | 87 | 47 | 30 | 208 | 1 | 1 24 06 161 | |
| | • 125 | 228 | 162 | 103 | 79 | 50 | 38 | 254 | 1 | 1 24 06 182 | |
| 200 | • 160 | 254 | 210 | 110 | 96 | 55 | 45 | 265 | 1 | 1 24 06 201 | |

Disponibilidad: ● Stock, □ 5-6 días, *Consultar

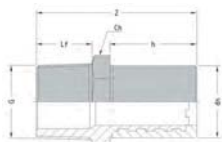

TRANSICIÓN MACHO

| dn | G | Dimensiones (mm) | | | | ud/caja | SDR 7,4 PN25 |
|-------|--------|------------------|----|-----|-----|---------|--------------|
| | | Lf | h | Z | Ch | | Código |
| • 20 | 1/2" | 15 | 41 | 61 | 22 | 30 | 1 36 50 020 |
| • 25 | 3/4" | 16 | 41 | 62 | 27 | 30 | 1 36 50 025 |
| • 32 | 1" | 19 | 44 | 70 | 34 | 30 | 1 36 50 032 |
| • 40 | 1" 1/4 | 21 | 49 | 78 | 42 | 12 | 1 36 50 040 |
| • 50 | 1" 1/2 | 23 | 55 | 88 | 52 | 16 | 1 36 50 050 |
| • 63 | 2" | 26 | 63 | 100 | 65 | 20 | 1 36 50 063 |
| • 75 | 2" 1/2 | 31 | 70 | 113 | 86 | 1 | 1 36 50 075 |
| • 90 | 3" | 34 | 79 | 125 | 97 | 1 | 1 36 50 090 |
| • 110 | 4" | 40 | 82 | 134 | 125 | 1 | 1 36 50 110 |

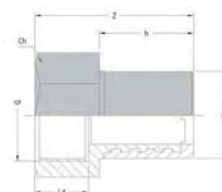

TRANSICIÓN HEMBRA

| dn | G | Dimensiones (mm) | | | | ud/caja | SDR 7,4 PN25 |
|-------|--------|------------------|----|-----|-----|---------|--------------|
| | | Lf | h | Z | Ch | | Código |
| • 20 | 1/2" | 15 | 41 | 59 | 27 | 30 | 1 36 52 020 |
| • 25 | 3/4" | 17 | 41 | 61 | 34 | 30 | 1 36 52 025 |
| • 32 | 1" | 19 | 44 | 66 | 40 | 30 | 1 36 52 032 |
| • 40 | 1" 1/4 | 21 | 49 | 76 | 50 | 12 | 1 36 52 040 |
| • 50 | 1" 1/2 | 21 | 55 | 82 | 55 | 16 | 1 36 52 050 |
| • 63 | 2" | 28 | 63 | 96 | 67 | 20 | 1 36 52 063 |
| • 75 | 2" 1/2 | 34 | 70 | 109 | 86 | 1 | 1 36 52 075 |
| • 90 | 3" | 37 | 79 | 121 | 97 | 1 | 1 36 52 090 |
| • 110 | 4" | 43 | 82 | 130 | 125 | 1 | 1 36 52 110 |

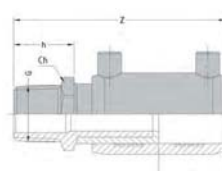

MANGUITO TRANSICIÓN ELECTROSOLDABLE MACHO

| dn | G | Dimensiones (mm) | | | | ud/caja | SDR 7,4 PN25 |
|-------|--------|------------------|----|-----|-----|---------|--------------|
| | | Lf | h | Z | Ch | | Código |
| □ 20 | 1/2" | 33 | 20 | 96 | 22 | 24 | 1 26 50 020 |
| □ 25 | 3/4" | 33 | 21 | 97 | 27 | 20 | 1 26 50 025 |
| □ 32 | 1" | 38 | 26 | 111 | 34 | 10 | 1 26 50 032 |
| □ 40 | 1" 1/4 | 44 | 29 | 124 | 42 | 5 | 1 26 50 040 |
| □ 50 | 1" 1/2 | 49 | 33 | 139 | 52 | 3 | 1 26 50 050 |
| □ 63 | 2" | 54 | 37 | 158 | 65 | 4 | 1 26 50 063 |
| □ 75 | 2" 1/2 | 60 | 43 | 173 | 86 | 1 | 1 26 50 075 |
| □ 90 | 3" | 65 | 46 | 190 | 97 | 1 | 1 26 50 090 |
| □ 110 | 4" | 70 | 52 | 204 | 125 | 1 | 1 26 50 110 |

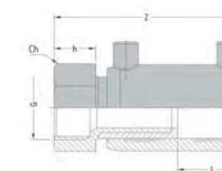

MANGUITO TRANSICIÓN ELECTROSOLDABLE HEMBRA

| dn | G | Dimensiones (mm) | | | | ud/caja | SDR 7,4 PN25 |
|-------|--------|------------------|----|-----|-----|---------|--------------|
| | | Lf | h | Z | Ch | | Código |
| □ 20 | 1/2" | 33 | 18 | 94 | 27 | 24 | 1 26 52 020 |
| □ 25 | 3/4" | 33 | 20 | 96 | 34 | 20 | 1 26 52 025 |
| □ 32 | 1" | 38 | 22 | 107 | 40 | 10 | 1 26 52 032 |
| □ 40 | 1" 1/4 | 44 | 27 | 122 | 50 | 5 | 1 26 52 040 |
| □ 50 | 1" 1/2 | 49 | 27 | 133 | 55 | 3 | 1 26 52 050 |
| □ 63 | 2" | 54 | 33 | 154 | 67 | 4 | 1 26 52 063 |
| □ 75 | 2" 1/2 | 60 | 39 | 169 | 86 | 1 | 1 26 52 075 |
| □ 90 | 3" | 65 | 42 | 186 | 97 | 1 | 1 26 52 090 |
| □ 110 | 4" | 70 | 48 | 200 | 125 | 1 | 1 26 52 110 |

Disponibilidad: ● Stock, □ 5-6 días, *Consultar

TARIFA PVP A-Presión

Accesorios PE Electrosoldable
para Tuberías PE-100

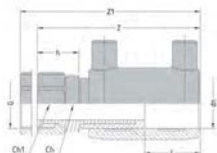

MANGUITO TRANSICIÓN TUERCA LOCA HEMBRA

| dn | G | Dimensiones (mm) | | | | | | ud/caja | SDR 7,4 PN25 |
|------|--------|------------------|----|-----|-----|----|-----|---------|--------------|
| | | L | h | Z | z1 | Ch | Ch1 | | Código |
| □ 20 | 1/2" | 33 | 22 | 98 | 108 | 22 | 27 | 24 | 1 26 53 020 |
| □ 25 | 3/4" | 33 | 22 | 98 | 108 | 27 | 30 | 15 | 1 26 53 025 |
| ● 32 | 1" | 38 | 27 | 112 | 120 | 32 | 36 | 10 | 1 26 53 032 |
| □ 40 | 1" 1/4 | 44 | 30 | 125 | 141 | 42 | 50 | 5 | 1 26 53 040 |
| ● 50 | 1" 1/2 | 49 | 32 | 137 | 152 | 52 | 58 | 3 | 1 26 53 050 |
| ● 63 | 2" | 54 | 39 | 160 | 183 | 65 | 67 | 4 | 1 26 53 063 |

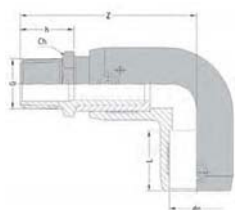

TRANSICIÓN 90° MACHO

| dn | G | Dimensiones (mm) | | | | ud/caja | SDR 7,4 PN25 |
|-------|--------|------------------|----|-----|-----|---------|--------------|
| | | Lf | h | Z | Ch | | Código |
| □ 20 | 1/2" | 33 | 20 | 81 | 22 | 10 | 1 26 51 020 |
| □ 25 | 3/4" | 33 | 21 | 83 | 27 | 8 | 1 26 51 025 |
| □ 32 | 1" | 39 | 26 | 106 | 34 | 10 | 1 26 51 032 |
| □ 40 | 1" 1/4 | 48 | 29 | 114 | 42 | 8 | 1 26 51 040 |
| □ 50 | 1" 1/2 | 54 | 33 | 129 | 52 | 5 | 1 26 51 050 |
| □ 63 | 2" | 52 | 37 | 151 | 65 | 2 | 1 26 51 063 |
| □ 75 | 2" 1/2 | 64 | 43 | 169 | 86 | 1 | 1 26 51 075 |
| □ 90 | 3" | 70 | 46 | 190 | 97 | 1 | 1 26 51 090 |
| □ 110 | 4" | 76 | 52 | 210 | 125 | 1 | 1 26 51 110 |

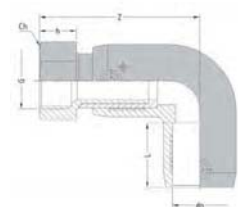

TRANSICIÓN 90° HEMBRA

| dn | G | Dimensiones (mm) | | | | ud/caja | SDR 7,4 PN25 |
|-------|--------|------------------|----|-----|-----|---------|--------------|
| | | Lf | h | Z | Ch | | Código |
| □ 20 | 1/2" | 33 | 18 | 79 | 27 | 10 | 1 26 53 120 |
| □ 25 | 3/4" | 33 | 20 | 82 | 34 | 8 | 1 26 53 125 |
| □ 32 | 1" | 39 | 22 | 102 | 40 | 10 | 1 26 53 132 |
| □ 40 | 1" 1/4 | 48 | 27 | 111 | 50 | 8 | 1 26 53 140 |
| □ 50 | 1" 1/2 | 54 | 27 | 121 | 55 | 5 | 1 26 53 150 |
| □ 63 | 2" | 52 | 33 | 147 | 67 | 2 | 1 26 53 163 |
| □ 75 | 2" 1/2 | 64 | 39 | 165 | 86 | 1 | 1 26 53 175 |
| □ 90 | 3" | 70 | 42 | 186 | 97 | 1 | 1 26 53 190 |
| □ 110 | 4" | 76 | 48 | 206 | 125 | 1 | 1 26 53 195 |

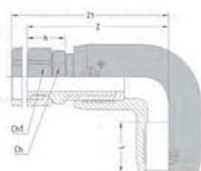

TRANSICIÓN 90° TUERCA LOCA HEMBRA

| dn | G | Dimensiones (mm) | | | | | | ud/caja | SDR 7,4 PN25 |
|------|--------|------------------|----|-----|-----|----|-----|---------|--------------|
| | | L | h | Z | z1 | Ch | Ch1 | | Código |
| □ 25 | 3/4" | 33 | 22 | 84 | 94 | 27 | 30 | 8 | 1 26 54 025 |
| □ 32 | 1" | 39 | 27 | 106 | 114 | 32 | 36 | 10 | 1 26 54 032 |
| □ 40 | 1" 1/4 | 48 | 30 | 114 | 130 | 42 | 50 | 8 | 1 26 54 040 |
| □ 50 | 1" 1/2 | 54 | 32 | 126 | 141 | 52 | 58 | 5 | 1 26 54 050 |
| □ 63 | 2" | 52 | 39 | 153 | 176 | 65 | 67 | 2 | 1 26 54 063 |

Disponibilidad: ● Stock, □ 5-6 días, *Consultar

Accesorios PE Electro-soldable para Tuberías PE-100

TARIFA PVP A-Presión

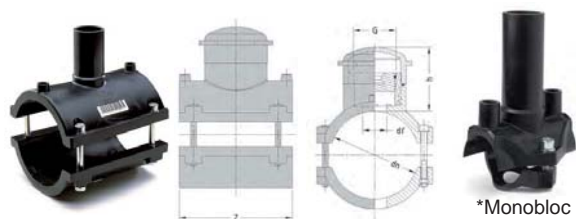

COLLARÍN ELECTROSOLDABLE TOMA SIMPLE

*Monobloc

| dn | dn1 | Dimensiones (mm) | | | | ud/caja | Código |
|------|-------|------------------|-----|-----|----|---------|-------------|
| | | h | h1 | Z | df | | |
| 40* | □ 20 | 65 | 99 | 84 | 13 | 1 | 1 24 62 040 |
| | □ 25 | 65 | 100 | 84 | 17 | 1 | 1 24 62 041 |
| | □ 32 | 65 | 101 | 84 | 25 | 1 | 1 24 62 042 |
| 50 | □ 20 | 52 | 159 | 101 | 13 | 1 | 1 24 62 050 |
| | □ 25 | 59 | 165 | 101 | 17 | 1 | 1 24 62 051 |
| | ● 32 | 110 | 170 | 101 | 25 | 1 | 1 24 62 052 |
| 63* | □ 20 | 60 | 110 | 110 | 13 | 1 | 1 24 62 063 |
| | ● 25 | 60 | 110 | 110 | 17 | 1 | 1 24 62 064 |
| | ● 32 | 65 | 112 | 110 | 25 | 1 | 1 24 62 065 |
| | □ 40 | 65 | 115 | 110 | 32 | 1 | 1 24 62 066 |
| | □ 50 | 80 | 135 | 110 | 38 | 1 | 1 24 62 067 |
| 75 | □ 63 | 65 | 140 | 122 | 48 | 1 | 1 24 62 068 |
| | ● 25 | 65 | 123 | 125 | 17 | 1 | 1 24 62 076 |
| | ● 32 | 65 | 123 | 125 | 25 | 1 | 1 24 62 077 |
| | □ 40 | 70 | 128 | 125 | 32 | 1 | 1 24 62 078 |
| | ● 50 | 80 | 144 | 125 | 38 | 1 | 1 24 62 079 |
| 90 | □ 63 | 90 | 159 | 125 | 48 | 1 | 1 24 62 080 |
| | □ 20 | 55 | 121 | 125 | 13 | 1 | 1 24 62 090 |
| | ● 25 | 55 | 121 | 125 | 17 | 1 | 1 24 62 091 |
| | ● 32 | 55 | 121 | 125 | 25 | 1 | 1 24 62 092 |
| | □ 40 | 60 | 126 | 125 | 32 | 1 | 1 24 62 093 |
| 110* | ● 50 | 65 | 137 | 125 | 38 | 1 | 1 24 62 094 |
| | ● 63 | 73 | 150 | 125 | 48 | 1 | 1 24 06 095 |
| | ● 25 | 60 | 137 | 162 | 17 | 1 | 1 24 62 111 |
| | ● 32 | 65 | 141 | 162 | 25 | 1 | 1 24 62 112 |
| | □ 40 | 65 | 141 | 162 | 32 | 1 | 1 24 62 113 |
| 125 | ● 50 | 80 | 161 | 162 | 38 | 1 | 1 24 62 114 |
| | ● 63 | 85 | 170 | 162 | 48 | 1 | 1 24 62 115 |
| | ● 25 | 56 | 143 | 160 | 17 | 1 | 1 24 62 126 |
| | ● 32 | 57 | 143 | 160 | 25 | 1 | 1 24 62 127 |
| | □ 40 | 62 | 147 | 160 | 32 | 1 | 1 24 62 128 |
| 140 | ● 50 | 67 | 158 | 160 | 38 | 1 | 1 24 62 129 |
| | ● 63 | 75 | 173 | 160 | 48 | 1 | 1 24 62 130 |
| | □ 90 | 93 | 191 | 190 | 72 | 1 | 1 24 62 132 |
| | □ 25 | 65 | 159 | 160 | 17 | 1 | 1 24 62 141 |
| | □ 32 | 65 | 159 | 160 | 25 | 1 | 1 24 62 142 |
| 160 | □ 40 | 70 | 163 | 160 | 32 | 1 | 1 24 62 143 |
| | □ 50 | 80 | 179 | 160 | 38 | 1 | 1 24 62 144 |
| | ● 63 | 90 | 194 | 160 | 48 | 1 | 1 24 62 145 |
| | ● 25 | 65 | 169 | 160 | 17 | 1 | 1 24 62 161 |
| | ● 32 | 65 | 169 | 160 | 25 | 1 | 1 24 62 162 |
| 180 | □ 40 | 73 | 173 | 160 | 32 | 1 | 1 24 62 163 |
| | ● 50 | 80 | 189 | 160 | 38 | 1 | 1 24 62 164 |
| | ● 63 | 90 | 204 | 160 | 48 | 1 | 1 24 62 165 |
| | ● 90 | 90 | 208 | 190 | 72 | 1 | 1 24 62 167 |
| | ● 110 | 96 | 216 | 160 | 88 | 1 | 1 24 62 168 |
| 200 | □ 25 | 56 | 221 | 160 | 17 | 1 | 1 24 62 180 |
| | ● 32 | 65 | 179 | 160 | 25 | 1 | 1 24 62 181 |
| | □ 40 | 70 | 183 | 160 | 32 | 1 | 1 24 62 182 |
| | □ 50 | 80 | 199 | 160 | 38 | 1 | 1 24 62 183 |
| | ● 63 | 90 | 214 | 160 | 48 | 1 | 1 24 62 184 |
| 225 | □ 90 | 93 | 218 | 190 | 72 | 1 | 1 24 62 187 |
| | □ 110 | 94 | 226 | 190 | 88 | 1 | 1 24 62 188 |
| | □ 25 | 65 | 189 | 160 | 17 | 1 | 1 24 62 200 |
| | ● 32 | 65 | 189 | 160 | 25 | 1 | 1 24 62 201 |
| | □ 40 | 70 | 193 | 160 | 32 | 1 | 1 24 62 202 |
| 250 | ● 50 | 80 | 210 | 160 | 38 | 1 | 1 24 62 203 |
| | ● 63 | 90 | 225 | 160 | 48 | 1 | 1 24 62 205 |
| | ● 90 | 93 | 229 | 190 | 72 | 1 | 1 24 62 207 |
| | ● 110 | 93 | 237 | 190 | 88 | 1 | 1 24 62 208 |
| | □ 25 | 65 | 201 | 160 | 17 | 1 | 1 24 62 225 |
| 250 | ● 32 | 65 | 201 | 160 | 25 | 1 | 1 24 62 226 |
| | □ 40 | 70 | 206 | 160 | 32 | 1 | 1 24 62 227 |
| | □ 50 | 80 | 222 | 160 | 38 | 1 | 1 24 62 228 |
| | □ 63 | 90 | 237 | 190 | 48 | 1 | 1 24 62 229 |
| | □ 90 | 93 | 241 | 190 | 72 | 1 | 1 24 62 232 |
| 250 | □ 110 | 98 | 249 | 190 | 88 | 1 | 1 24 62 233 |
| | ● 32 | 58 | 205 | 190 | 25 | 1 | 1 24 62 250 |
| | □ 40 | 63 | 210 | 190 | 32 | 1 | 1 24 62 251 |
| | ● 50 | 68 | 221 | 190 | 38 | 1 | 1 24 62 252 |
| | ● 63 | 77 | 234 | 190 | 48 | 1 | 1 24 62 253 |
| 250 | ● 90 | 93 | 254 | 190 | 72 | 1 | 1 24 62 257 |
| | ● 110 | 98 | 262 | 190 | 88 | 1 | 1 24 62 258 |

*Modelo Monobloc

Disponibilidad: ● Stock, □ 5-6 días, *Consultar

TARIFA PVP A-Presión

Accesorios PE Electro-soldable
para Tuberías PE-100

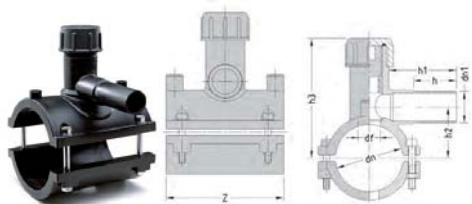

*Monobloc

COLLARÍN ELECTROSOLDABLE TOMA EN CARGA

| dn | dn1 | Dimensiones (mm) | | | | | | ud/caja | Código |
|------|------|------------------|----|-----|-----|-----|-----|---------|-------------|
| | | df | h | h1 | h2 | h3 | Z | | |
| 40* | □ 20 | | 66 | 96 | 29 | 110 | 84 | 1 | 1 24 64 040 |
| | □ 25 | | 66 | 96 | 29 | 110 | 84 | 1 | 1 24 64 041 |
| | □ 32 | | 66 | 96 | 29 | 110 | 84 | 1 | 1 24 64 042 |
| 50 | □ 20 | 16 | 50 | 54 | 71 | 131 | 101 | 1 | 1 24 64 050 |
| | □ 25 | 16 | 54 | 54 | 71 | 131 | 101 | 1 | 1 24 64 051 |
| | □ 32 | 18 | 60 | 78 | 40 | 102 | 102 | 1 | 1 24 64 052 |
| 63 | □ 20 | 25 | 70 | 90 | 55 | 136 | 110 | 1 | 1 24 64 063 |
| | ● 25 | 25 | 70 | 90 | 55 | 136 | 110 | 1 | 1 24 64 064 |
| | ● 32 | 25 | 70 | 105 | 55 | 136 | 110 | 1 | 1 24 64 065 |
| | □ 40 | 25 | 70 | 120 | 55 | 136 | 110 | 1 | 1 24 64 066 |
| 75 | □ 20 | 25 | 70 | 90 | 63 | 133 | 125 | 1 | 1 24 64 075 |
| | ● 25 | 25 | 70 | 90 | 63 | 133 | 125 | 1 | 1 24 64 076 |
| | ● 32 | 25 | 70 | 107 | 74 | 133 | 125 | 1 | 1 24 64 077 |
| | □ 40 | 25 | 72 | 120 | 63 | 133 | 125 | 1 | 1 24 64 078 |
| | □ 50 | 30 | 72 | 120 | 63 | 160 | 125 | 1 | 1 24 64 079 |
| | □ 63 | 30 | 93 | 120 | 63 | 160 | 125 | 1 | 1 24 64 080 |
| 90 | □ 20 | 25 | 70 | 90 | 70 | 146 | 125 | 1 | 1 24 64 090 |
| | □ 25 | 25 | 70 | 90 | 70 | 146 | 125 | 1 | 1 24 64 091 |
| | □ 32 | 25 | 70 | 105 | 70 | 146 | 125 | 1 | 1 24 64 092 |
| | □ 40 | 25 | 72 | 120 | 70 | 146 | 125 | 1 | 1 24 64 093 |
| | □ 50 | 30 | 72 | 120 | 73 | 171 | 125 | 1 | 1 24 64 094 |
| | □ 63 | 30 | 93 | 120 | 73 | 171 | 125 | 1 | 1 24 64 095 |
| 110* | □ 20 | | 76 | 130 | 71 | 208 | 162 | 1 | 1 24 64 110 |
| | ● 25 | | 76 | 130 | 71 | 208 | 162 | 1 | 1 24 64 111 |
| | ● 32 | | 76 | 135 | 71 | 208 | 162 | 1 | 1 24 64 112 |
| | □ 40 | | 76 | 139 | 71 | 208 | 162 | 1 | 1 24 64 113 |
| | ● 50 | | 80 | 144 | 71 | 208 | 162 | 1 | 1 24 64 114 |
| | □ 63 | | 85 | 148 | 71 | 208 | 162 | 1 | 1 24 64 115 |
| 125 | ● 20 | 25 | 70 | 90 | 87 | 165 | 160 | 1 | 1 24 64 125 |
| | ● 25 | 25 | 70 | 90 | 87 | 165 | 160 | 1 | 1 24 64 126 |
| | □ 32 | 25 | 70 | 108 | 87 | 165 | 160 | 1 | 1 24 64 127 |
| | □ 40 | 25 | 72 | 120 | 87 | 165 | 160 | 1 | 1 24 64 128 |
| | ● 50 | 30 | 72 | 120 | 87 | 187 | 160 | 1 | 1 24 64 129 |
| | □ 63 | 30 | 83 | 120 | 87 | 187 | 160 | 1 | 1 24 64 130 |
| 140 | ● 20 | 25 | 70 | 90 | 96 | 165 | 160 | 1 | 1 24 64 140 |
| | ● 25 | 25 | 70 | 90 | 96 | 165 | 160 | 1 | 1 24 64 141 |
| | □ 32 | 25 | 70 | 90 | 96 | 165 | 160 | 1 | 1 24 64 142 |
| | □ 40 | 25 | 72 | 120 | 96 | 165 | 160 | 1 | 1 24 64 143 |
| | □ 50 | 30 | 72 | 120 | 96 | 167 | 160 | 1 | 1 24 64 144 |
| | ● 63 | 30 | 73 | 120 | 96 | 167 | 160 | 1 | 1 24 64 145 |
| 160 | □ 20 | 25 | 70 | 90 | 108 | 184 | 160 | 1 | 1 24 64 160 |
| | ● 25 | 25 | 70 | 90 | 104 | 184 | 160 | 1 | 1 24 64 161 |
| | ● 32 | 25 | 70 | 106 | 105 | 185 | 160 | 1 | 1 24 64 162 |
| | □ 40 | 25 | 72 | 120 | 104 | 185 | 160 | 1 | 1 24 64 163 |
| | □ 50 | 30 | 72 | 120 | 104 | 208 | 160 | 1 | 1 24 64 164 |
| | ● 63 | 30 | 72 | 120 | 104 | 208 | 160 | 1 | 1 24 64 165 |
| 180 | □ 20 | 25 | 70 | 90 | 110 | 192 | 160 | 1 | 1 24 64 180 |
| | □ 25 | 25 | 70 | 90 | 110 | 192 | 160 | 1 | 1 24 64 181 |
| | ● 32 | 25 | 70 | 105 | 110 | 192 | 160 | 1 | 1 24 64 182 |
| | □ 40 | 25 | 72 | 120 | 110 | 192 | 160 | 1 | 1 24 64 183 |
| | □ 50 | 30 | 72 | 120 | 110 | 194 | 160 | 1 | 1 24 64 184 |
| | □ 63 | 30 | 72 | 120 | 110 | 194 | 160 | 1 | 1 24 64 185 |
| 200 | □ 20 | 25 | 70 | 90 | 126 | 204 | 160 | 1 | 1 24 64 200 |
| | ● 25 | 25 | 70 | 90 | 126 | 204 | 160 | 1 | 1 24 64 201 |
| | ● 32 | 25 | 70 | 105 | 126 | 204 | 160 | 1 | 1 24 64 202 |
| | □ 40 | 25 | 72 | 120 | 126 | 204 | 160 | 1 | 1 24 64 203 |
| | □ 50 | 30 | 72 | 120 | 126 | 194 | 160 | 1 | 1 24 64 204 |
| | ● 63 | 30 | 64 | 120 | 126 | 194 | 160 | 1 | 1 24 64 205 |
| 225 | □ 20 | 25 | 70 | 90 | 140 | 216 | 160 | 1 | 1 24 64 225 |
| | □ 25 | 25 | 70 | 90 | 140 | 216 | 160 | 1 | 1 24 64 226 |
| | ● 32 | 25 | 70 | 105 | 140 | 216 | 160 | 1 | 1 24 64 227 |
| | □ 40 | 25 | 72 | 120 | 140 | 216 | 160 | 1 | 1 24 64 228 |
| | □ 50 | 30 | 72 | 120 | 140 | 218 | 160 | 1 | 1 24 64 229 |
| | □ 63 | 30 | 64 | 120 | 140 | 218 | 160 | 1 | 1 24 64 230 |
| 250 | □ 20 | 25 | 70 | 90 | 151 | 264 | 160 | 1 | 1 24 64 250 |
| | ● 25 | 25 | 70 | 90 | 151 | 264 | 160 | 1 | 1 24 64 251 |
| | ● 32 | 30 | 70 | 105 | 151 | 266 | 160 | 1 | 1 24 64 252 |
| | □ 40 | 30 | 72 | 120 | 151 | 266 | 160 | 1 | 1 24 64 253 |
| | □ 50 | 30 | 72 | 120 | 151 | 266 | 160 | 1 | 1 24 64 254 |
| | ● 63 | 30 | 64 | 120 | 151 | 266 | 160 | 1 | 1 24 64 255 |

*Modelo Monobloc

Disponibilidad: ● Stock, □ 5-6 días, *Consultar